

# 45

YEARS OF RELIABILITY  
SINCE 1975.



# RELIABLE

SLEEVES & ENGINEERING PRODUCTS

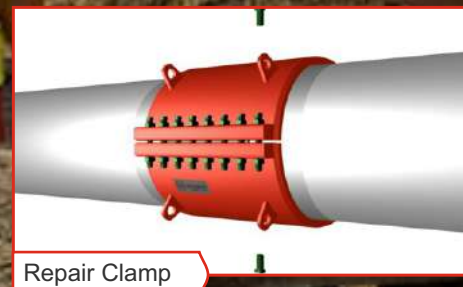

## SPECIAL PRODUCTS FOR OIL & GAS INDUSTRIES



**INSERT PIPE SLEEVE**



**HALF PIPE SLEEVE**



**SPLIT REPAIR CLAMP**



**GALVANISED WALL  
SLEEVES**

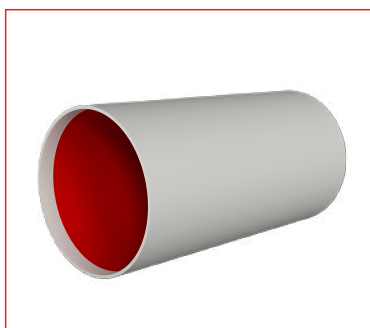

**INTERNALLY COATED PIPE**

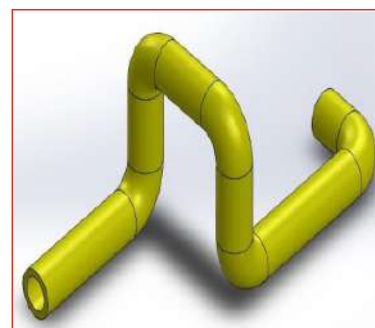

**COATED PIPE SPOOL**

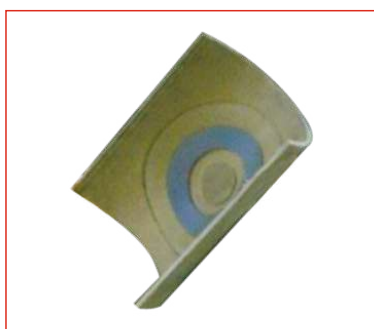

**LEAK DEFECT REPAIR  
SLEEVES**



**MACHINING COMPONENTS**



**CEMENT MOTOR  
SLEEVES**

## INSERT SLEEVES / PIPE SLEEVES

SPECIALITY : WE ARE THE ONLY MANUFACTURER TO PRODUCE 72" OD INSERT / PIPE SLEEVES

### AFRICA



### INDIA



### SOUTH AMERICA



### MIDDLE EAST



### EUROPE



PIPE SLEEVE  
INSERT SLEEVE  
INSERT PIPE SLEEVE

INTERNAL SLEEVE  
INTERNAL PIPE SLEEVE  
INTERNALLY COATED PIPE SLEEVE

The application of the product is onshore & offshore pipeline installation for weld line & inner coating protection. All internal coated pipelines are under the risk of weld line corrosion and internal coating damage due to the heat created by welding process while installation of the material. The solution is Reliable Sleeves & Engineering Products an cost effective and easy to use solution.

### APPLICATION:-

1. Oil & Gas
2. Water Injection Lines
3. Fire Water & Salt Water Piping
4. Internal Coated Pipelines
5. Onshore & Offshore pipeline installation etc.
6. Cement Mortar Line
7. Highly corrosive gas piping
8. Potable & Waste Water
9. Jet Fuel transfer
10. Fire Water & Salt Water piping

### MATERIAL:-

- API 5L Gr B, X42, X46, X52, X56, X 60, X 65, X70 - PSL 1 - PSL2
- ASTM A516 GR55, GR60, GR65, Gr70

**SIZE:- 2" TO 72"**

## HALF PIPE SLEEVE



HALF REPAIR SLEEVE  
FULL ENCIRCLEMENT STEEL SLEEVE  
TYPE A SLEEVE  
TYPE B SLEEVE  
PRESTRESSED METALLIC SLEEVE

STEEL REPAIR SLEEVES  
HALF SOLE SEGMENTS  
SPLIT REINFORCING SLEEVE  
WELD ON REPAIR SLEEVE  
GIRTH WELD SLEEVE

Half Repair pipe Sleeves are designed to avoid a costly shut down. Existing lines can be cased without thru-put loss, because it is not necessary to shut down the carrier line to perform the required repair. A full scope of sizes, ASTM grades of steel plate (structural and pressure vessel quality), wall thickness and longitudinal edge options are available.

Half Sole Repair Sleeves, also called split casing or half wrap, are custom-fabricated to your specifications, to assure a precision product and secure fit.

### MATERIAL

- API 5L Gr B, X42, X46, X52, X56, X 60, X 65, X70 - PSL 1 - PSL2
- ASTM A36
- ASTM A572 GR42, GR50, GR55, GR60, Gr65
- ASTM A516 GR55, GR60, GR65, Gr70
- ASTM A537 Class I, Class 2, Class 3
- EN 10025 - S235, S275, S355, S450

*\*ANY OTHER MATERIAL CAN BE USED AS PER CLIENT REQUIREMENT*

**SIZE :-** 1" TO 100"

**LENGTH :-** Upto 6 Mtrs

## LEAK REPAIR CLAMP

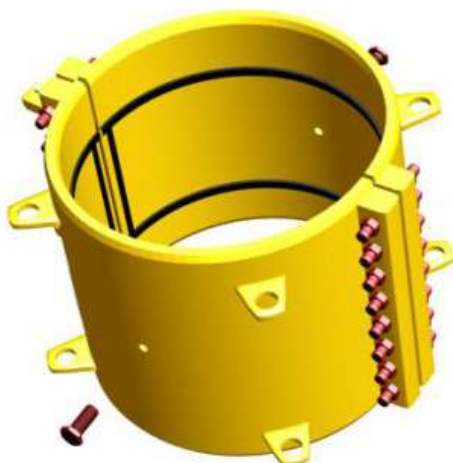

LEAK REPAIR CLAMP  
SPLIT SLEEVE  
SPLIT REPAIR CLAMP  
HIGH PRESSURE CLAMP

SPLIT REPAIR CLAMP  
BOLT ON REPAIR CLAMP  
CLAMP SLEEVE

RSEP offers a complete line of Split Repair Clamp that allows pipeline owners and operators to secure defective sections of pipe that are cracked, corroded (internally or externally), dented, damaged, or leaking. Split Repair Clamps provide sealing of damaged pipe without shutting down or disrupting the critical service. The Split Repair Clamps halves are connected by a bolt to form a high-pressure vessel around the damaged pipe.

### BENEFITS:

- Can be used in cases of leaking pipes or where wall thinning occurs
- They are self-sealing, achieved by bolting of the clamp studs
- Standard clamps come in single seal arrangement, but double seal arrangement can be provided upon request
- Hydro tested to 1.5 times the clamp design pressure (or as per your requirements)
- Widely used for subsea and topside repairs
- Provided with wedge shape grooves to prevent slipping of seals during installation
- Designed to ASME VIII
- Can be provided with prep angles for welding on the pipeline as and when required

**SIZE :- 2" TO 48"**

**PRESSURE RATING :- 300#, 400#, 600#, 900# & 1500#**  
or any other as per client requirement.

## LEAK DEFECT REPAIR SLEEVE

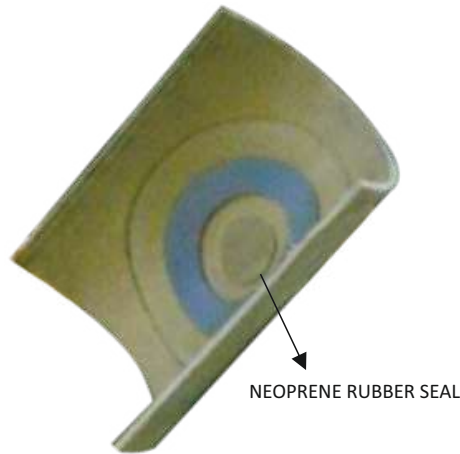

### ADVANTAGES

- Lightweight for easy handling and installation.
- Eliminates costly downtime.
- Minimizes repair costs.
- Complies with CSA Z183 and ANSI B31.4 Standards.

### MATERIAL

- API 5L Gr B, X42, X46, X52, X56, X 60, X 65, X70 - PSL 1 - PSL2
- ASTM A36
- ASTM A572 GR42, GR50, GR55, GR60, Gr65
- ASTM A516 GR55, GR60, GR65, Gr70
- ASTM A537 Class I, Class 2, Class 3
- EN 10025 - S235, S275, S355, S450

*\*ANY OTHER MATERIAL CAN BE USED AS PER CLIENT REQUIREMENTS*

**SIZE :- 1" TO 100"**

**LENGTH :- Upto 6 Mtrs**

## GALVANIZED WALL SLEEVES



Wall penetration sleeves provide a corrosion-resistant sealing surface for pipes penetrating floors, walls, foundation, or any concrete barrier.

Pipe Wall Sleeves are an option to create a hole penetration in a concrete wall. They are placed into the frame before pouring, and leave a clean hole. A water stop ring is provided. The Wall Sleeves have pipes and conduit running through them that can be sealed with the RELIABLE GALVANIZED SLEEVE product.

### FEATURES AND BENEFITS

- Steel Wall Sleeves available in Painted (Model WS) or Galvanized (Model WSG)
- 2" (50.8 mm) Steel Collar (water-stop)
- Continuous Weld-Bead on both sides of collar (water-stop)
- May be order to any length.
- Special order diameters and schedule pipe available on request

### MATERIAL

- API 5L Gr B, X42, X46, X52, X56, X 60, X 65, X70 - PSL 1 - PSL2
- ASTM A106 GR B / 53 GR B
- ASTM A 312 TP 304 / 316

**SIZE :- 1" TO 100"**

## CARBON STEEL INTERNALLY & EXTERNALLY COATED PIPE



Corrosion is the primary factor affecting the longevity and reliability of offshore and onshore buried pipelines throughout the world. Epoxy coatings offer excellent resistance to high temperatures, chemicals and corrosion. Oil and gas protective coatings can be divided into two separate categories, each with its own unique and demanding requirements: External Coatings and Internal Coatings. When referred to anti-corrosion, people naturally think of the external anti-corrosion, such as three layer Polyethylene Systems(3LPE) and three polypropylene layer(3LPP), but the internal pipeline coating is as the same important as external coating for protection of the

TYPES OF COATING
INTERNAL COATINGS
Liquid Epoxy Coating
Fusion Bonded Epoxy Coating
High Build Epoxy Coating
Cement Motor Lining Coating
Food Grade Epoxy Coating
3LPE Coating
EXTERNAL COATINGS
Liquid Epoxy Coating
Fusion Bonded Epoxy Coating
High Build Epoxy Coating
Cement Motor Lining Coating
Food Grade Epoxy Coating

FUSION BONDED EPOXY COATING
3M SCOTCHKOTE 134
3M SCOTCHKOTE XC 6171
KCC-IC-4888
JOTUN JOTAPIPE AC 1003
AKZONOBEL CORVEL 10-6051
AKZONOBEL CORVEL 10-8158
AKZONOBEL RESICOAT HKF47R
AKZONOBEL RESICOAT HJH01R
AKZONOBEL RESICOAT HGH02R
AKZONOBEL RESICOAT HLF2AQF
AKZONOBEL RESICOAT HNF13QF

LIQUID EPOXY COATING
HEMPEL HEMPADUR 85671
HEMPEL HEMPADUR 45881
HEMPEL HEMPADUR MULTI-STRENGTH GF 35870
HEMPEL HEMPADUR MULTI-STRENGTH 35530
CARBOLINE PLASITE 7159
ENVIROLINE 405HT
INTERTHERM 228
INTERLINE 850
INTERLINE 984
INTERZONE 954
SIGMALINE 2000
SIGMA SHIELD 1200
SIGMA NOVAGUARD 840
PHENGUARD 930
SIGMA EPH 7497

### MATERIAL

- API 5L Gr B, X42, X46, X52, X56, X 60, X 65, X70 - PSL 1 - PSL2
- SOUR SERVICE, HIC / SSC TESTED, NACE
- ERW, SEAMLESS, LSAW PIPES

**SIZE :-** 2" TO 100"

**LENGTH :-** Upto 12 Mtrs

## MACHINED COMPONENTS



RELI-SLEEVE is an accomplished CNC & VMC machining company & manufacturer of various components.

- Swiss Turning
- CNC Turning & Chucking
- CNC Milling
- CNC Vertical & Horizontal Milling
- Grinding
- Secondary Machining
- Brazing
- Plate Milling
- Laser Cutting
- PLASMA CUTTING
- LATHE MACHINING
- CUTTING
- LASER CUTTING
- WATER JET CUTTING
- Slotting
- Knurling
- Threading
- Crimping
- Assembly

### MATERIAL

CARBON STEEL, STAINLESS STEEL, ALLOY STEEL, HIGH NICKLE ALLOYS, ALUMINIUM, SPECIAL GRADE STEEL

## CEMENT MOTOR SLEEVES

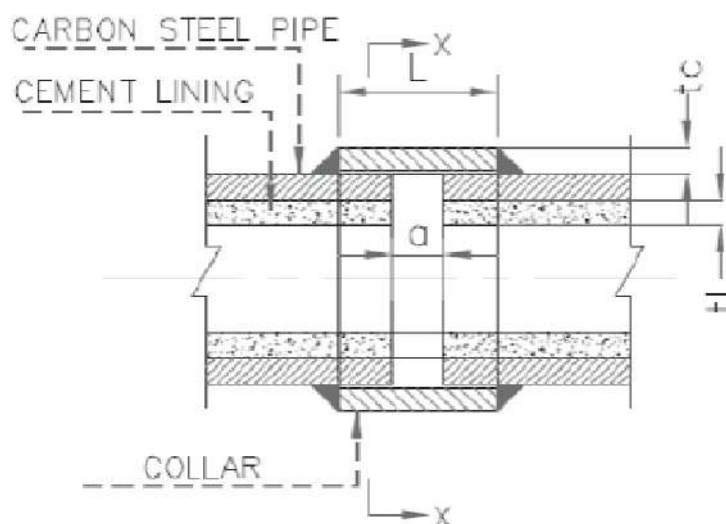

### CEMENT COLLAR

PIPE NB (INCH)	PIPE OD (DO) (mm)	COLLAR ID (Di) (mm)	COLLAR LENGTH L(mm)	COLLAR THICK tc (mm)
3"	88.97	92.7	110	10
4"	114.3	118.1	120	10
6"	168.275	172.7	130	10
8"	219.075	223.7	140	10
10"	273.05	278.2	200	12
12"	323.85	329	350	12
14"	355.6	316.2	275	12
16"	406.4	412.4	300	12
18"	457.2	463.8	325	12
20"	508	515.1	350	12
24"	609.6	617.9	350	12

## COATED PIPE SPOOL



A Pipe Spool is a prefabricated component of a piping system. Relisleeve is Piping Spool Fabrication Manufacturer in India. Pipe Spools bolt up to flanges and connect, these are often times used in big refineries connecting to ex-changers. Pipe Spools are made up of three components: pipes, flanges and fittings. A Pipe Spool drawing shows a single spool and is optimized to provide all the information needed by the fabrication shop to accurately manufacture or assemble the spool.

TYPES OF COATING
INTERNAL COATINGS
Liquid Epoxy Coating
Fusion Bonded Epoxy Coating
High Build Epoxy Coating
Cement Motor Lining Coating
Food Grade Epoxy Coating
3LPE Coating
EXTERNAL COATINGS
Liquid Epoxy Coating
Fusion Bonded Epoxy Coating
High Build Epoxy Coating
Cement Motor Lining Coating
Food Grade Epoxy Coating

FUSION BONDED EPOXY COATING
3M SCOTCHKOTE 134
3M SCOTCHKOTE XC 6171
KCC-IC-4888
JOTUN JOTAPIPE AC 1003
AKZONOBEL CORVEL 10-6051
AKZONOBEL CORVEL 10-8158
AKZONOBEL RESICOAT HKF47R
AKZONOBEL RESICOAT HJH01R
AKZONOBEL RESICOAT HGH02R
AKZONOBEL RESICOAT HLF2AQF
AKZONOBEL RESICOAT HNF13QF

LIQUID EPOXY COATING
HEMPEL HEMPADUR 85671
HEMPEL HEMPADUR 45881
HEMPEL HEMPADUR MULTI-STRENGTH GF 35870
HEMPEL HEMPADUR MULTI-STRENGTH 35530
CARBOLINE PLASITE 7159
ENVIROLINE 405HT
INTERTHERM 228
INTERLINE 850
INTERLINE 984
INTERZONE 954
SIGMALINE 2000
SIGMA SHIELD 1200
SIGMA NOVAGUARD 840
PHENGUARD 930
SIGMA EPH 7497

# We provide the solutions to your needs.

Reliable, is a part of Reliable Group of Companies serving Oil & Gas, Petro Chemical and various other industries from last 44 years. Established in 1975 Reliable is providing continuous innovation for problems faced in Oil & Gas Industry through major Research and Development activity. Reli Sleeve is the only company in the world which can manufacture sleeves in both liquid and powder coating and sizes from 2" OD upto 72" OD and also Customized as per client requirement and critical pipe sleeve with sour service application. Around 45 years back Reliable Group of companies started trading business supplying Steel Pipes & plates to the domestic market. Later it Started Importing International grades materials to meet the critical requirement of domestic consumers. Our aim is to provide complete business solution along with Reliability, Efficiency & Creativeness to worldwide clients at best competitive price and minimum delivery schedule. Reliable has its existence since 1975 loaded with vast experience of more than three decades towards engineering raw material and other related field. We believe our excellent background and experience can bring you more than you expect. Covering from the areas of trading, importing, manufacturing & exporting Reli Sleeve can comprehensively respond to customer's requirements stage by stage and always tries to give full responsibility to our customer in every field. Reliable is continuously developing innovative technology in each business field and trying to maximize customer satisfaction by materializing "The best value creating company" and opening a new Engineering culture of the 21C".

## CERTIFICATIONS AND APPROVALS



# Always at your service providing innovative, quality-based solutions



**RELIABLE**  
SLEEVES & ENGINEERING PRODUCTS



YEARS OF RELIABILITY  
SINCE 1975

“Our business decisions are taken in compliance with the highest ethical standards. We strive to achieve sustainable growth, always applying best practices and technologies to preserve the environment, the health and safety of our personnel and contractors as well as to constantly improve the quality of our products and services.”

*M. S. Mehta*  
- ByChairman



# RELIABLE

SLEEVES & ENGINEERING PRODUCTS

## HEAD OFFICE :

C-16, Anand Bhuvan, 163/165,  
V. P. Road, Mumbai - 400 004.  
Maharashtra, India.  
Phone : +91 22 43431313 (25 Lines)

## CORPORATE OFFICE :

29-B, Nakoda Bhavan, Sindhi Lane, Mumbai - 400 004.  
Fax : +91 22 23859458

## WORKS :

Plot No. F-8/4, Patalganga Industrial Area, Chavane, Panvel, Raigad,  
Maharashtra - 410220.  
(50 kms from Sea Port and 100 kms from Airport.)

**Abhilash Nair**

M: +91-8652211122/9324233293

P : +91-22-43431303

E : anair@reliablepipes.com  
sales@reliablefabrication. om

**Mr. Kamlesh India**

M: 91- +91 8108489547

P : +91-22-43431307

E : marketing@reliablepipes.com  
export@reliblepipes.com